

### LEGEND

SYMBOL DESCRIPTION	SYMBOL	NAME STYLE
INTERNATIONAL	☆☆☆☆☆☆☆☆	INTERNATIONAL
AMERICAN INDIAN RESERVATION	☆☆☆☆☆☆☆☆	AMERICAN INDIAN RESERVATION
ALASKA NATIVE REGIONAL CORPORATION	◇◇◇◇◇◇◇◇	ALASKA NATIVE REGIONAL CORPORATION
STATE <sup>1</sup>	□□□□□□□□	STATE
COUNTY <sup>1</sup>	□□□□□□□□	COUNTY
MINOR CIVIL DIVISION <sup>2</sup>	□□□□□□□□	MINOR CIVIL DIVISION
Incorporated Place	○	<b>Incorporated Place</b>
Unified School District	○	<b>Unified School District</b>
Secondary School District	○	<b>Secondary School District</b>
Elementary School District	○	<b>Elementary School District</b>
Interstate and Limited Access Highway	—	Interstate and Limited Access Highway
US Highway or Secondary Road	—	U.S. Highway or Secondary Road
County or Connecting Road	—	County or Connecting Road
Neighborhood Road or City Street	—	Neighborhood Road or City Street
Railroad	—	Railroad
Perennial Stream/Shoreline	—	Perennial Stream/Shoreline
Intermittent Stream/Shoreline	—	Intermittent Stream/Shoreline
Pipeline or Powerline	—	Pipeline or Powerline
Property Line	—	Property Line
River, Lake, or Other Water	—	River, Lake, or Other Water
Military	—	Military
Park/National Park	—	Park/National Park
INSET A	—	INSET A
Outside Jurisdiction	—	Outside Jurisdiction

<sup>1</sup> State or County; or their equivalent area for statistical purposes.  
<sup>2</sup> A five-sided material following a minor civil division name indicates that the minor civil division is coextensive with an incorporated place and has the same name.

### School Districts

Code	Name
17370	GRANT PARK COMMUNITY UNIT SCHOOL DISTRICT 6
24390	MANTENO COMMUNITY UNIT SCHOOL DISTRICT 5
26430	MOMENCE COMMUNITY UNIT SCHOOL DISTRICT 1
06960	BRADLEY BOURBONNAIS CONSOLIDATED HIGH SCHOOL DISTRICT 307
37320	ST GEORGE COMMUNITY CONSOLIDATED SCHOOL DISTRICT 258

### KEY TO LINEAR FEATURE NAMES

1 Greenwood Ct	3 Alma St	5 Park Lane Dr (Park St)	7 Lake Melongo Ct	9 W Mosler St
2 Bathfah Ave	4 W Hayden St (Hayden St)	6 S Starley St	8 E 1670N Rd	

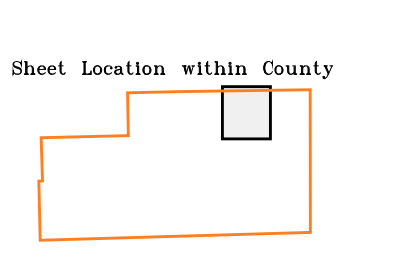
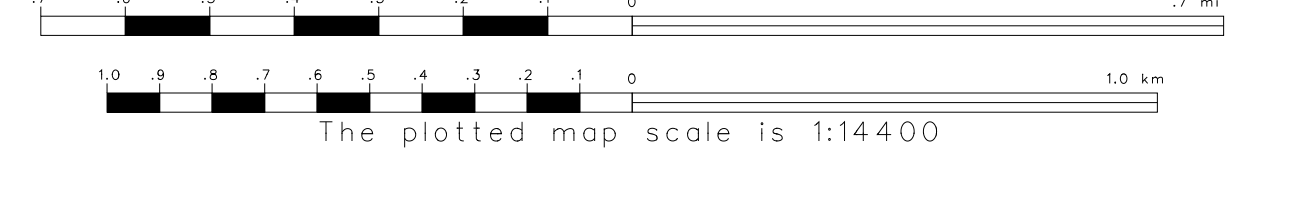
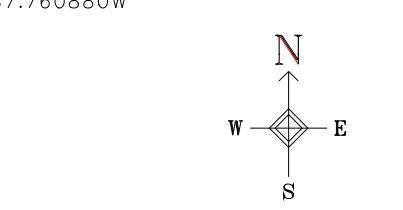
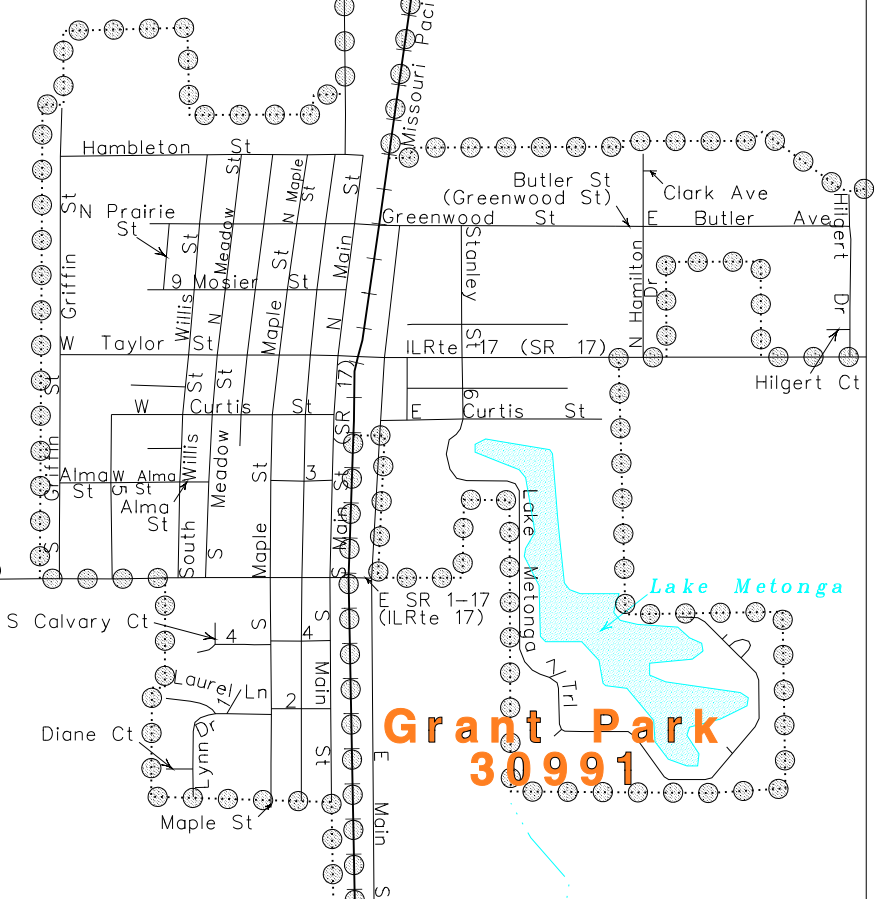

### Key to adjacent sheets

1	5	6
10	11	12

ST: Illinois (17)  
 COU: Kankakee County (091)

SHEET 5 OF 18 PARENT SHEETS  
 (SDA03) 0241709100500000000